

INSTALATION OF VENEER STONE ON AERATED CONCRETE BLOCKS

DETAIL OF BASIC COMPOSITION - VERTICAL SECTION

- ❶ Aerated concrete blocks (YTONG)
- ❷ Disperse coating WILD STONE HP
- ❸ Glass mesh (160g/m²) + WILD STONE LM
- ❹ Dowels 60 mm (6-8 pieces/1 m²)
- ❺ Washer Ø 40 mm/6 mm plastic
- ❻ Metal screws 6/60
- ❼ Adhesive WILD STONE LM
- ❽ Lightweight stone cladding WILD STONE
- ❾ Grout WILD STONE SH
- ❿ Water-repellent STONESIL AQUA

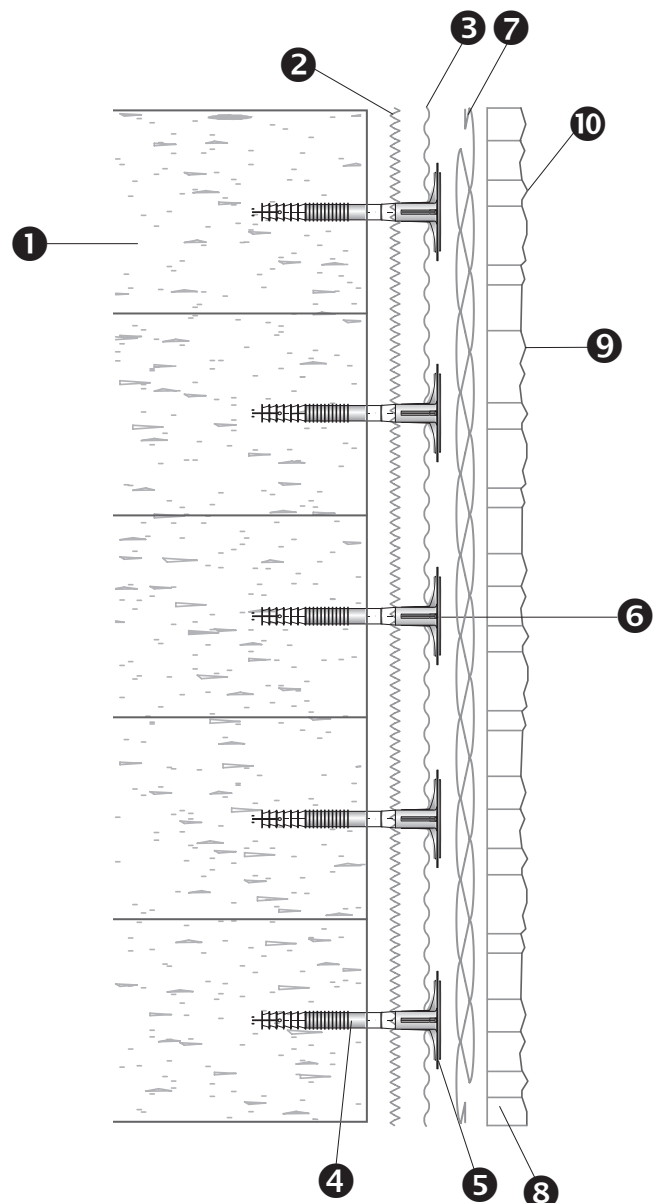

WS contact details:

WILD STONE international s.r.o., Podhořská 806/31, 180 00 Praha 8

ID: 267 23 174 • Tax ID: CZ267 23 174

Facility:

Politických vězňů 1986, 274 01 Slaný, tel.: +420 312 520 159, fax: +420 312 523 104, e-mail: info@wildstone.eu